



Level 1/581 Military Road Mosman NSW

Perfectly positioned in the heart of Mosman's retail hub, this 50 sqm* office suite is now available.

The suite is accessible via Military Road and has the convenience of rear direct access via the Mosman Square Council Car Park offering free 2 hour parking.

The premises is surrounded by long standing and successful retailers including Dan Murphy's, Caf Mosman, The design Store, Camilla and Marc, Venroy, The Upside, Pond Home, Camilla, Sarah & Sebastian and Mode Sportif.

Property Highlights:

- 50 sqm*
- Newly renovated in 1 year
- Bathroom facilities
- Front and rear access
- Direct access to Mosman Square Council Car Park

Building Size : 50 sqm

View

: <https://www.jami.com.au/lease/nsw/north-shore-lower/mosman/commercial/retail/7743379>



Jimmy Pan
02 8776 8707

Jane Lin
02 8776 8707

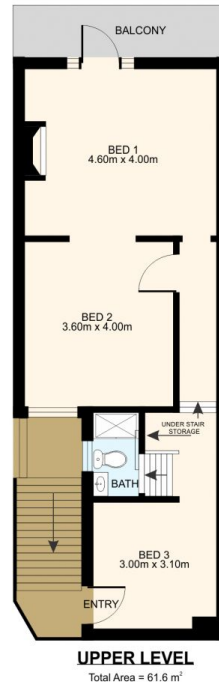
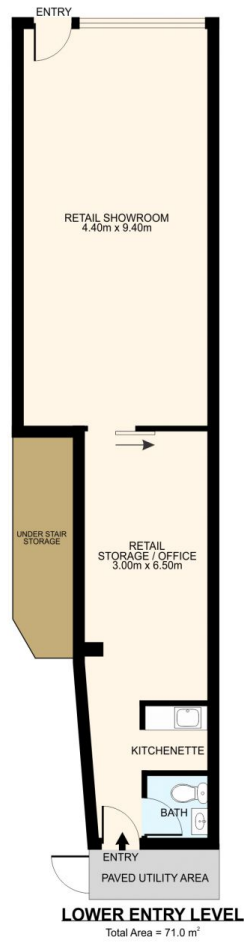

DISCLAIMER: THIS IS FOR ILLUSTRATIVE PURPOSES ONLY.
ALL DIMENSIONS ARE APPROXIMATE AND IT DOES NOT
CONSTITUTE PART OF ANY LEGAL DOCUMENTS.

ADDRESS:

581 Military Rd, Mosman